

An aerial photograph of the University of Illinois at Chicago campus. In the foreground, there are green lawns, trees, and a paved walkway with several people walking. A large, modern building with a grid-like facade is visible in the middle ground. In the background, the Chicago skyline is visible under a blue sky with scattered white clouds. The Willis Tower is the most prominent building in the skyline.

# **UIC Master Plan Update: 2018 Implementation Plan**

**Presentation to the University of Illinois Board of  
Trustees  
November 15, 2018**



# Project Timeline

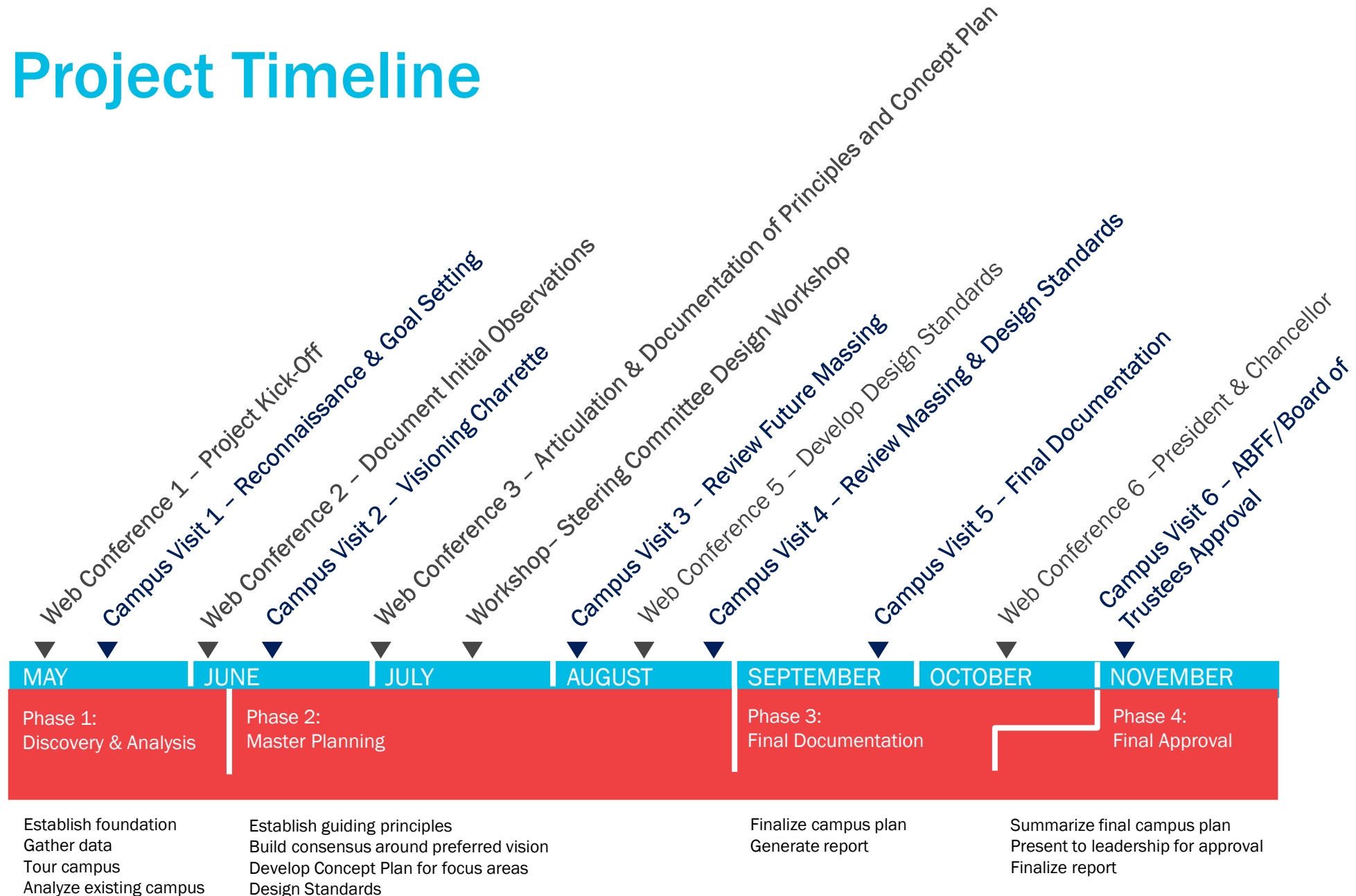

## Guiding Principles

1. Build appropriate environments to support academic and healthcare programs **Drive Excellence**
2. Create a welcoming setting that encourages people to linger **Enhance Identity**
3. Connect people and the campus to the city **Our Campus is Chicago**
4. Leverage campus heritage and change the physical paradigm to appeal to all **Transform UIC**

# UIC Master Plan Update: 2018 Implementation Plan

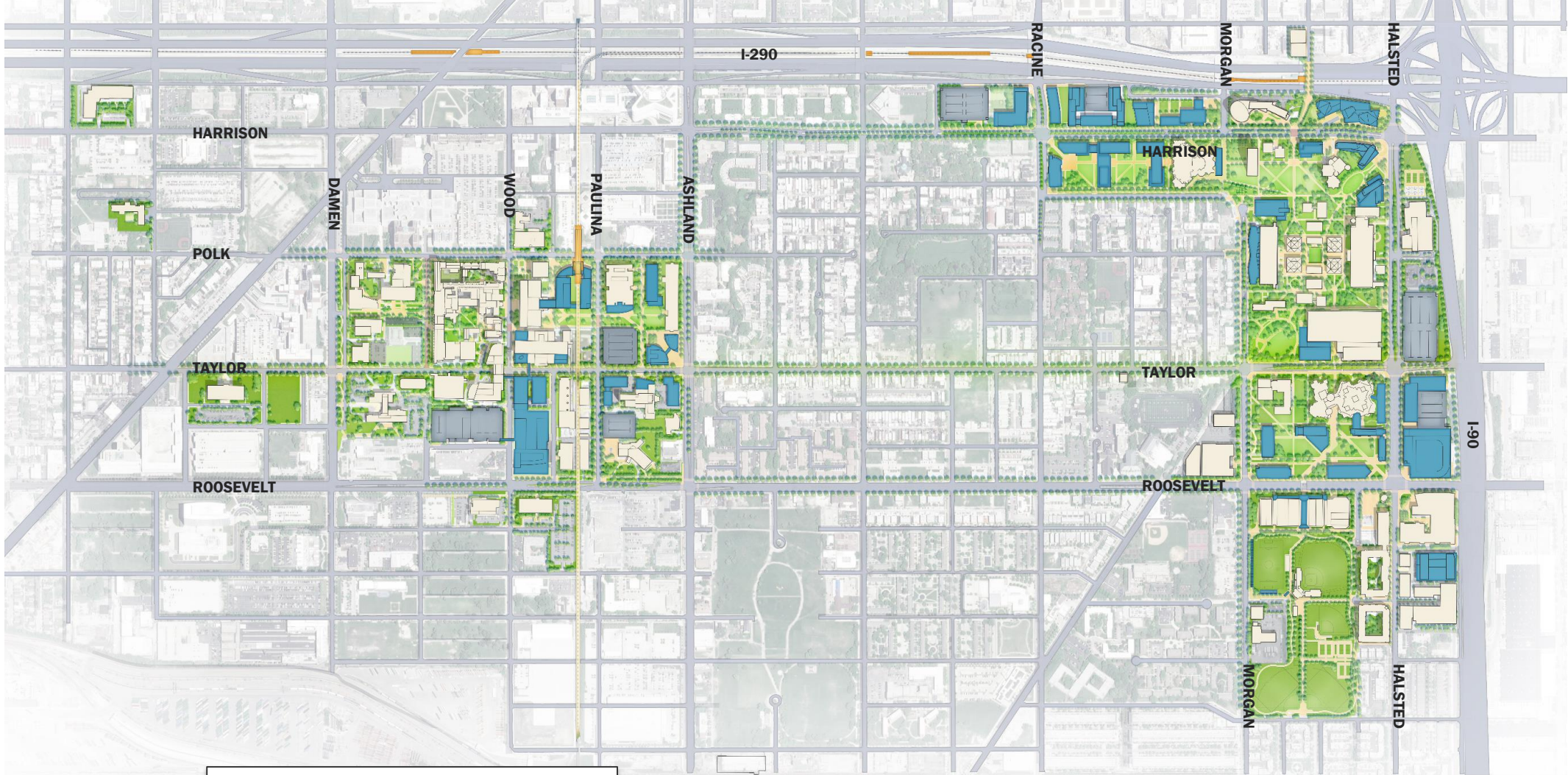

- EXISTING UIC BUILDING
- NEW UIC BUILDING
- NEW OR EXPANDED PARKING GARAGE



# Priority Focus Areas

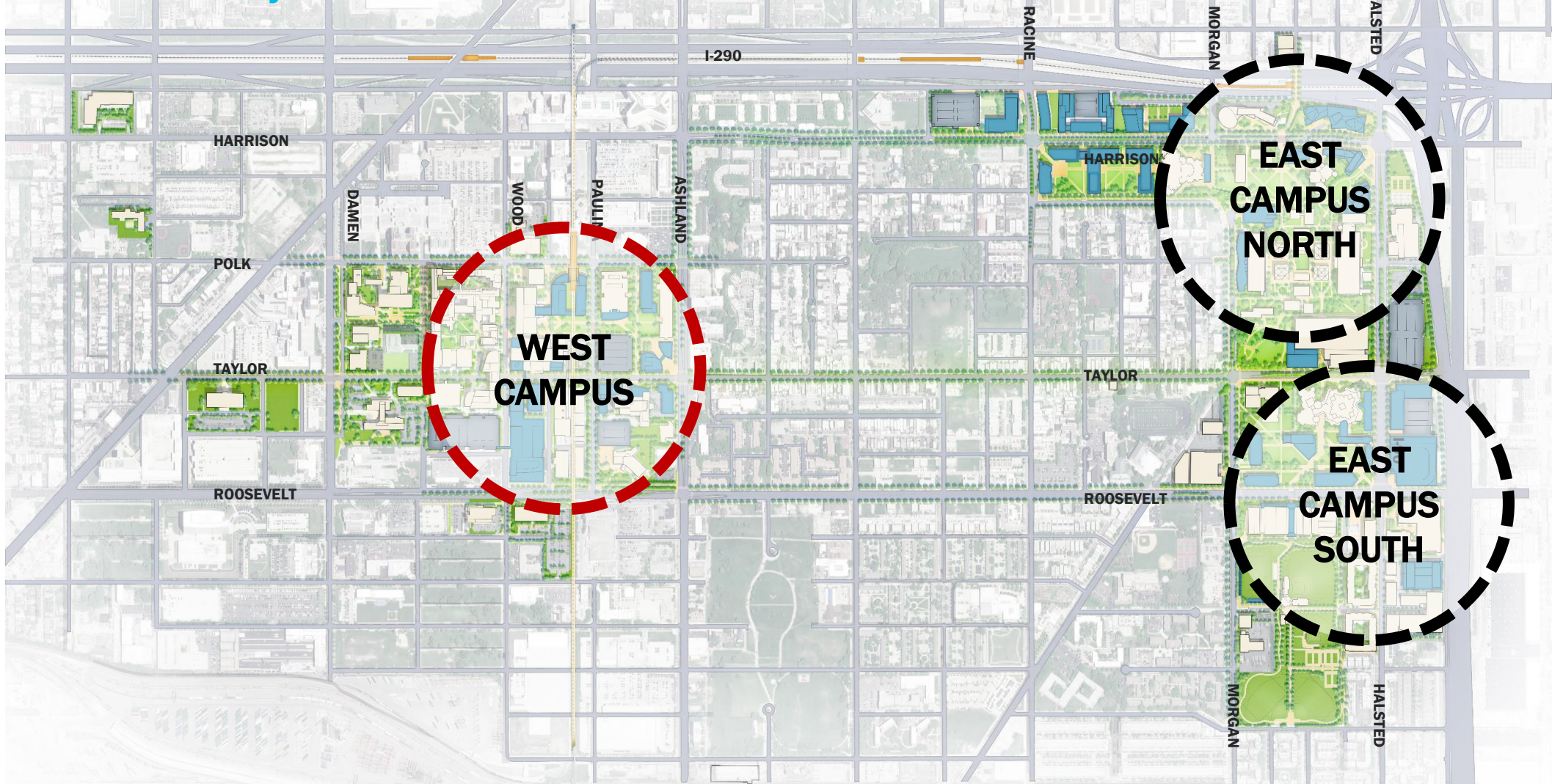

# West Campus – Existing

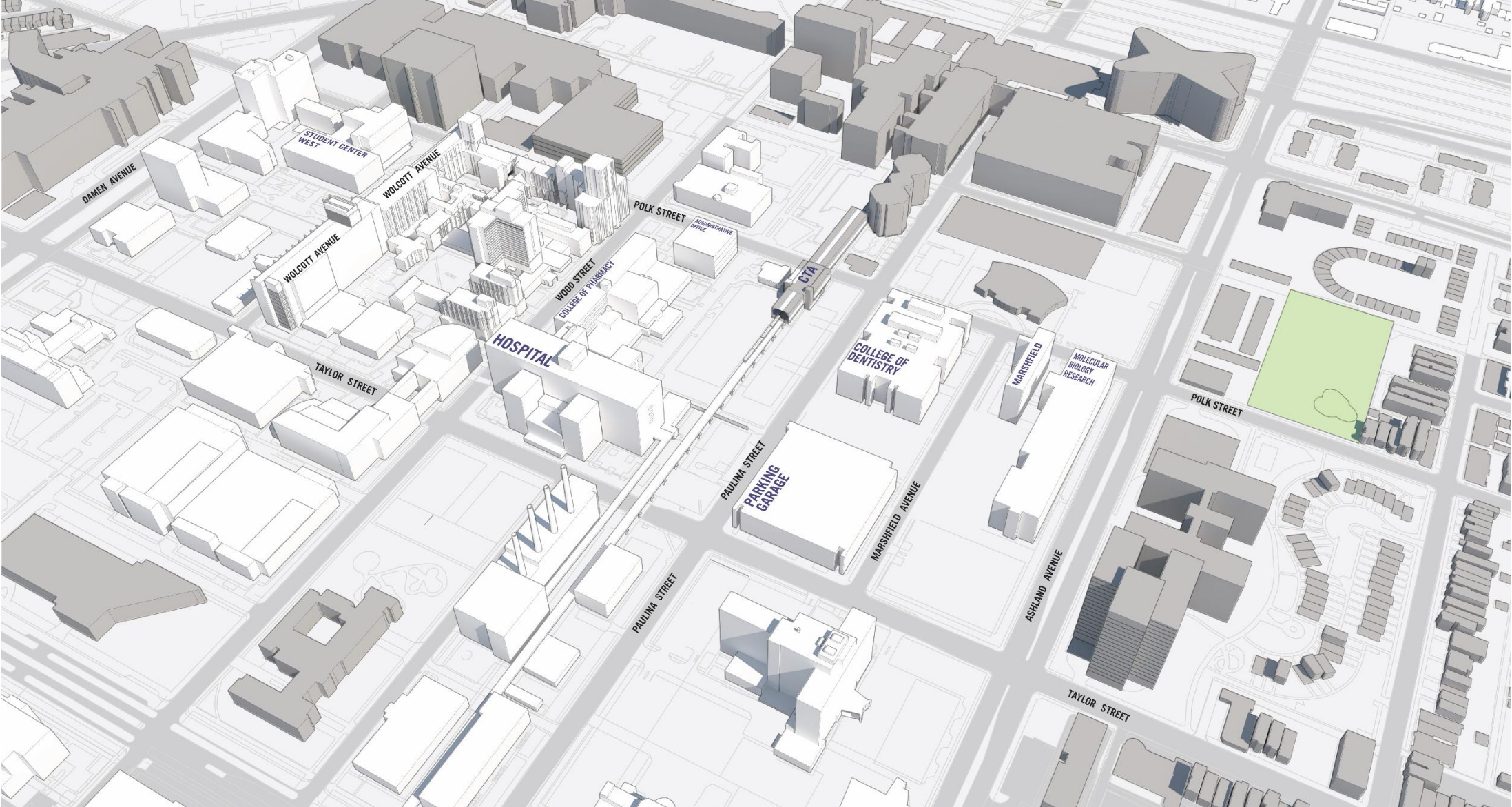

# West Campus – Proposed Design Strategy

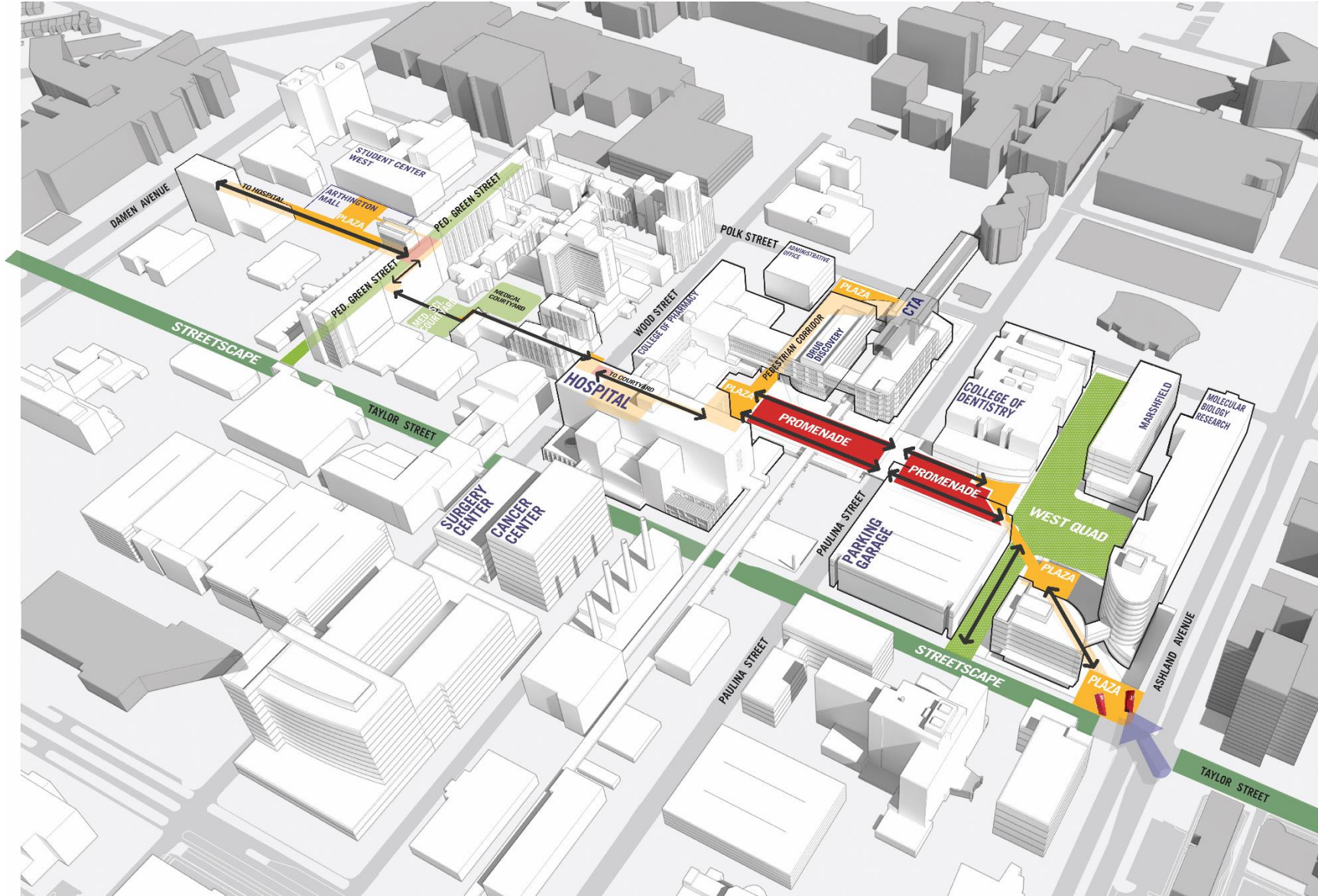

## ALIGN TO PRINCIPLES:

Create active, welcoming campus entries and edges

Build new facilities to support academic and healthcare programs

Reinforce collegiate feel to campus

Improve connections to and from the city

Create places for people to linger

Increase visibility and profile of UIC

# West Campus – Proposed Projects





# Polk Street CTA Station – Existing



# Polk Street CTA Station – Proposed



# Health Sciences Greenway - Existing

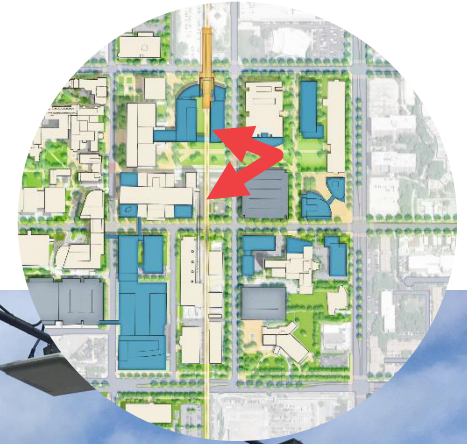

# Health Sciences Greenway – Proposed



# Campus & City Connections

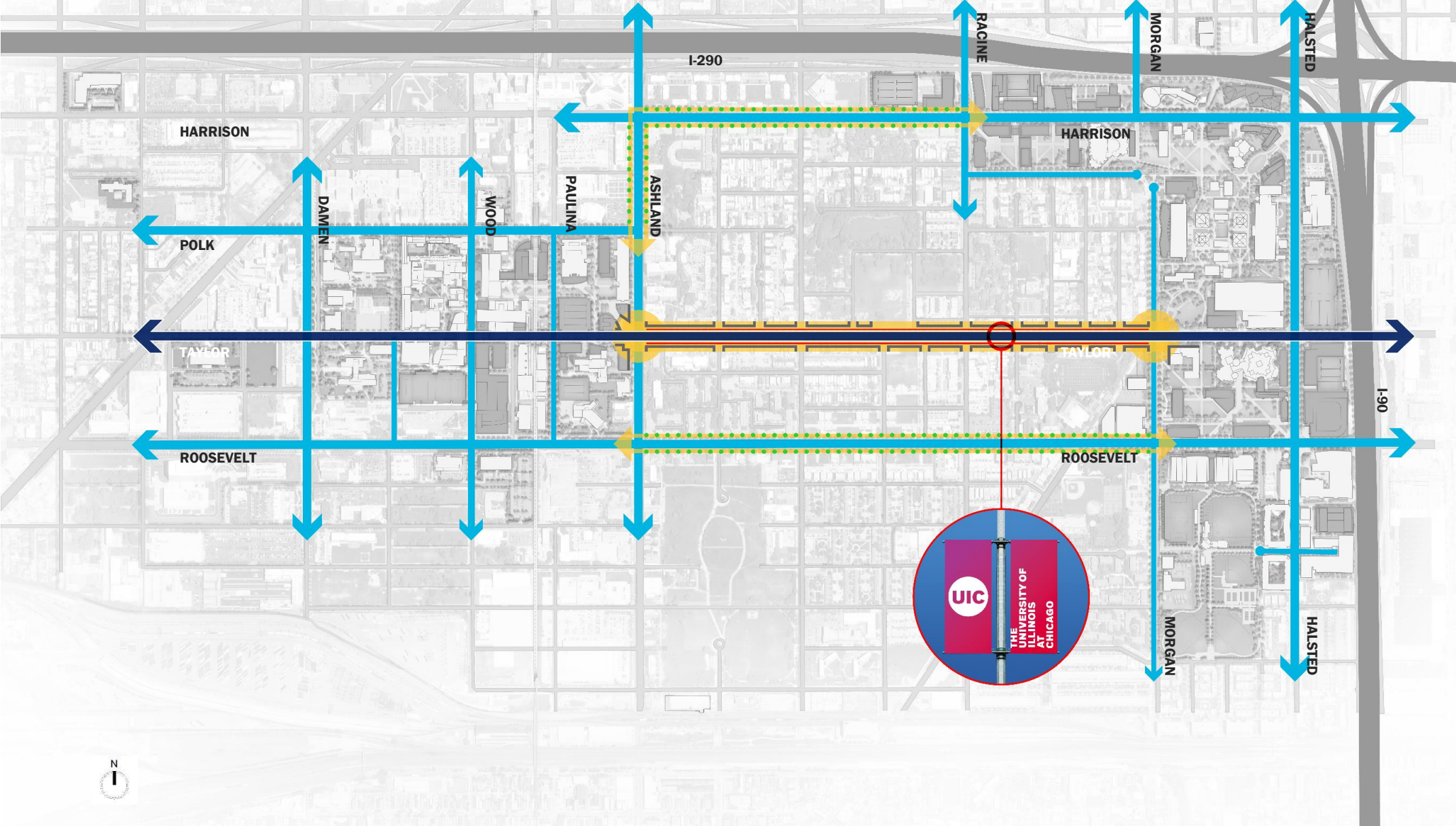

# Priority Focus Areas

HARRISON

POLK

TAYLOR

ROOSEVELT

ASHLAND

HALSTED

WEST  
CAMPUS

EAST  
CAMPUS  
NORTH

EAST  
CAMPUS  
SOUTH



# East Campus North – Existing

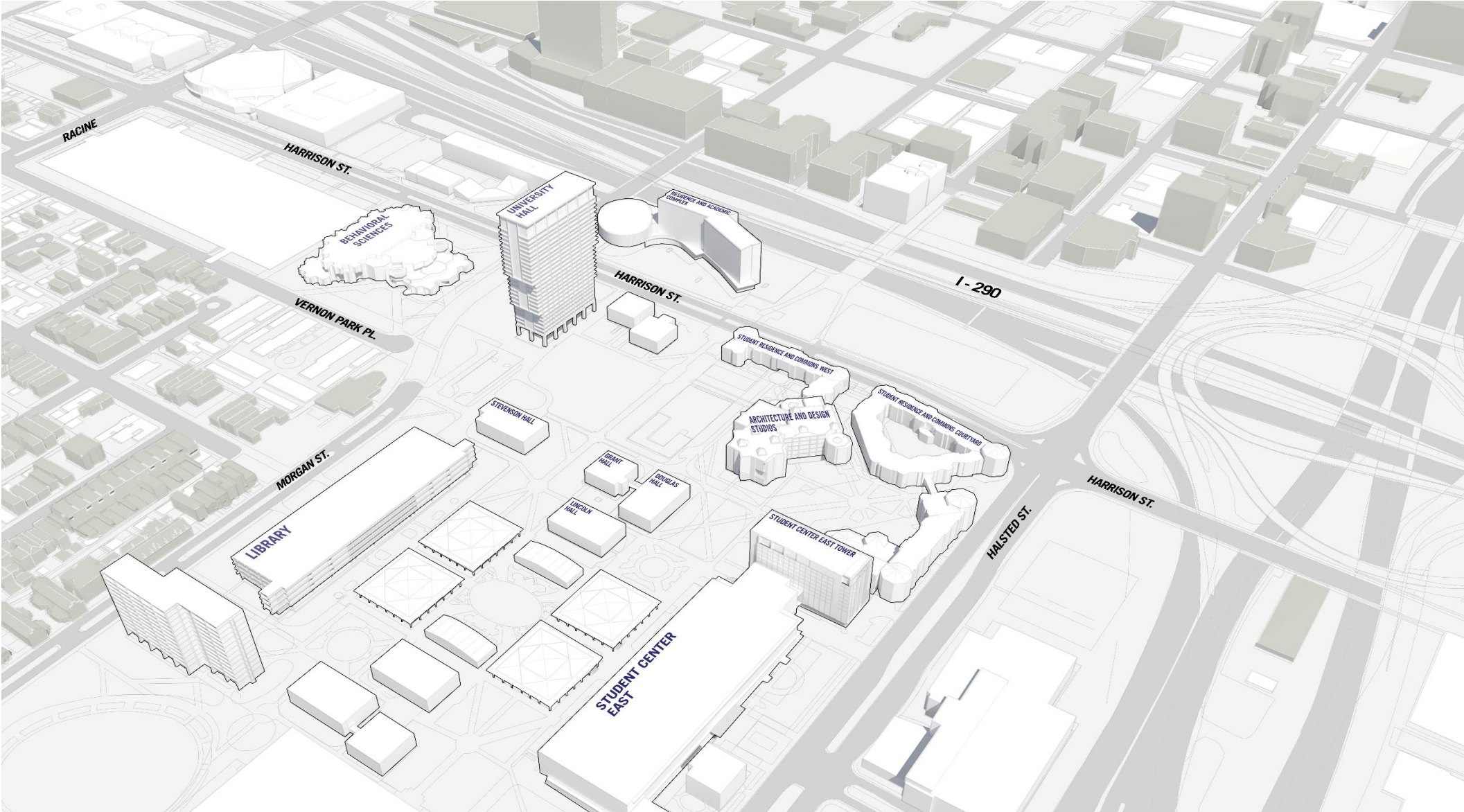
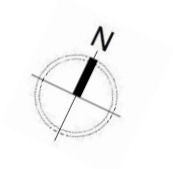

# East Campus North – Proposed Design Strategy

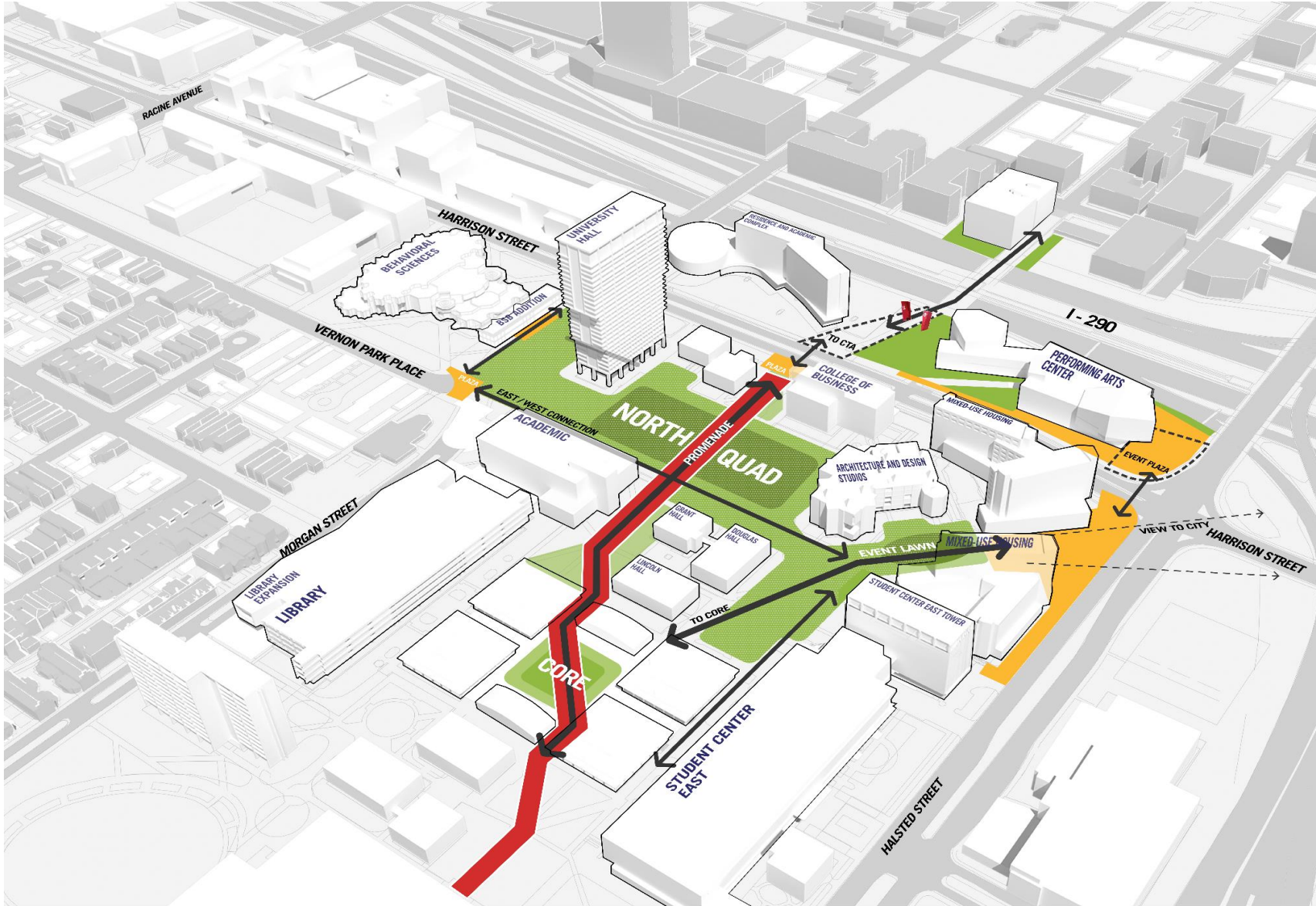

- ALIGN TO PRINCIPLES:**
- Create active, welcoming campus entries and edges
  - Build new facilities to support academic programs
  - Enhance the collegiate feel of the campus core
  - Improve connections to and from the city
  - Create places for people to linger
  - Establish a variety of open space experiences



# East Campus North – Proposed Projects

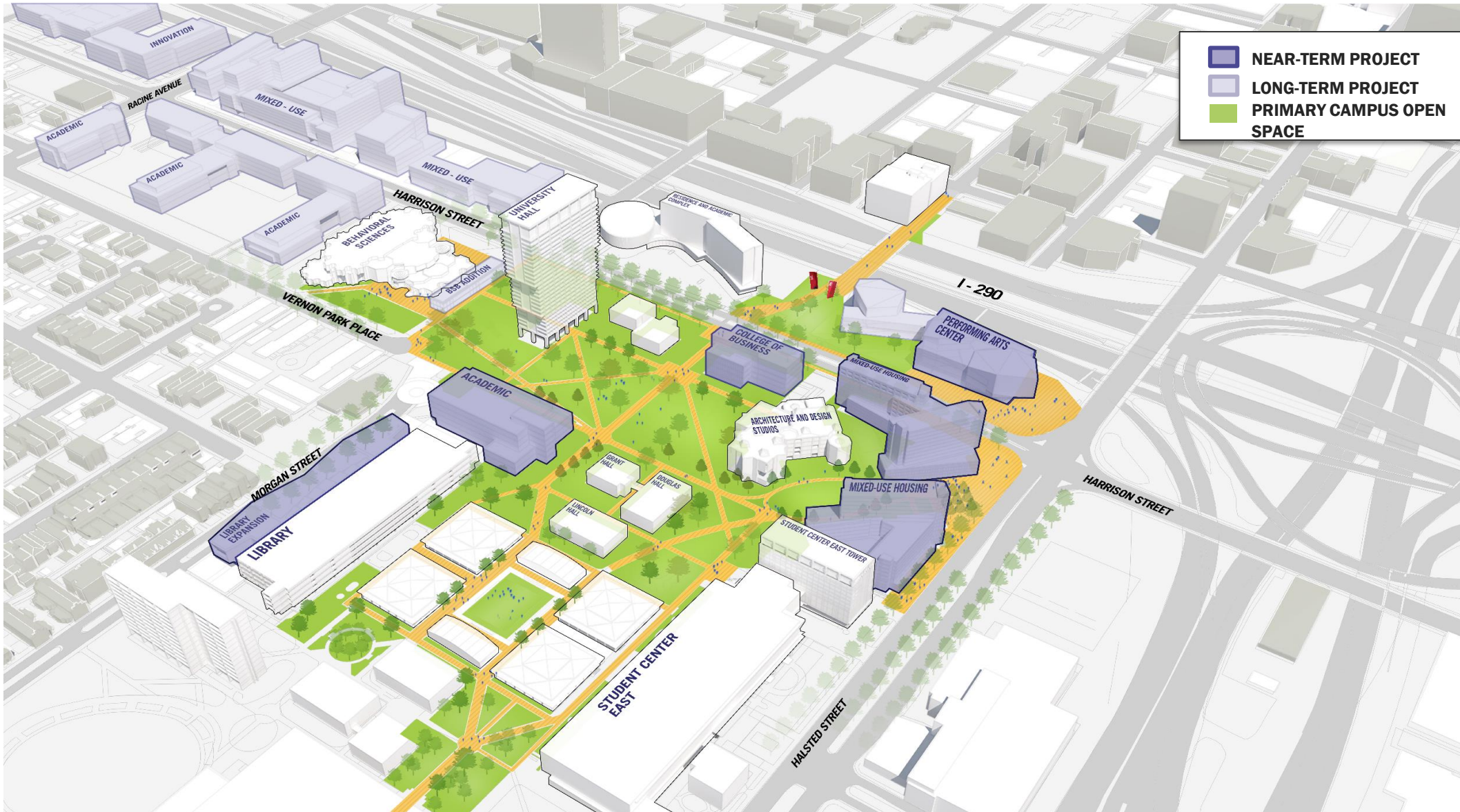

# Halsted Street Portal – Existing

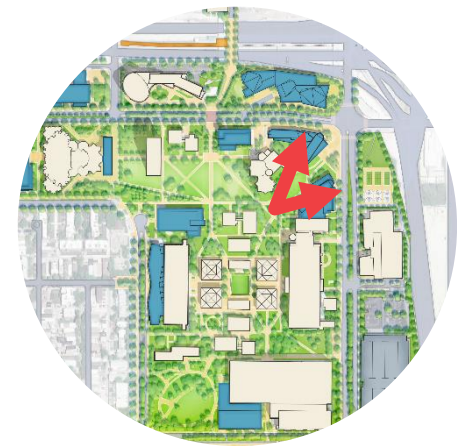

# Halsted Street Portal – Proposed



# Halsted Street Portal – Existing



# Halsted Street Portal – Proposed



# Harrison Street Crossing – Existing



# Harrison Street Crossing – Proposed



# Central Quad – Existing





# Central Quad – Proposed



# Central Quad – Proposed



# Priority Focus Areas

HARRISON

POLK

TAYLOR

ROOSEVELT

WEST  
CAMPUS

EAST  
CAMPUS  
NORTH

EAST  
CAMPUS  
SOUTH

ASHLAND

HALSTED



# East Campus South – Existing

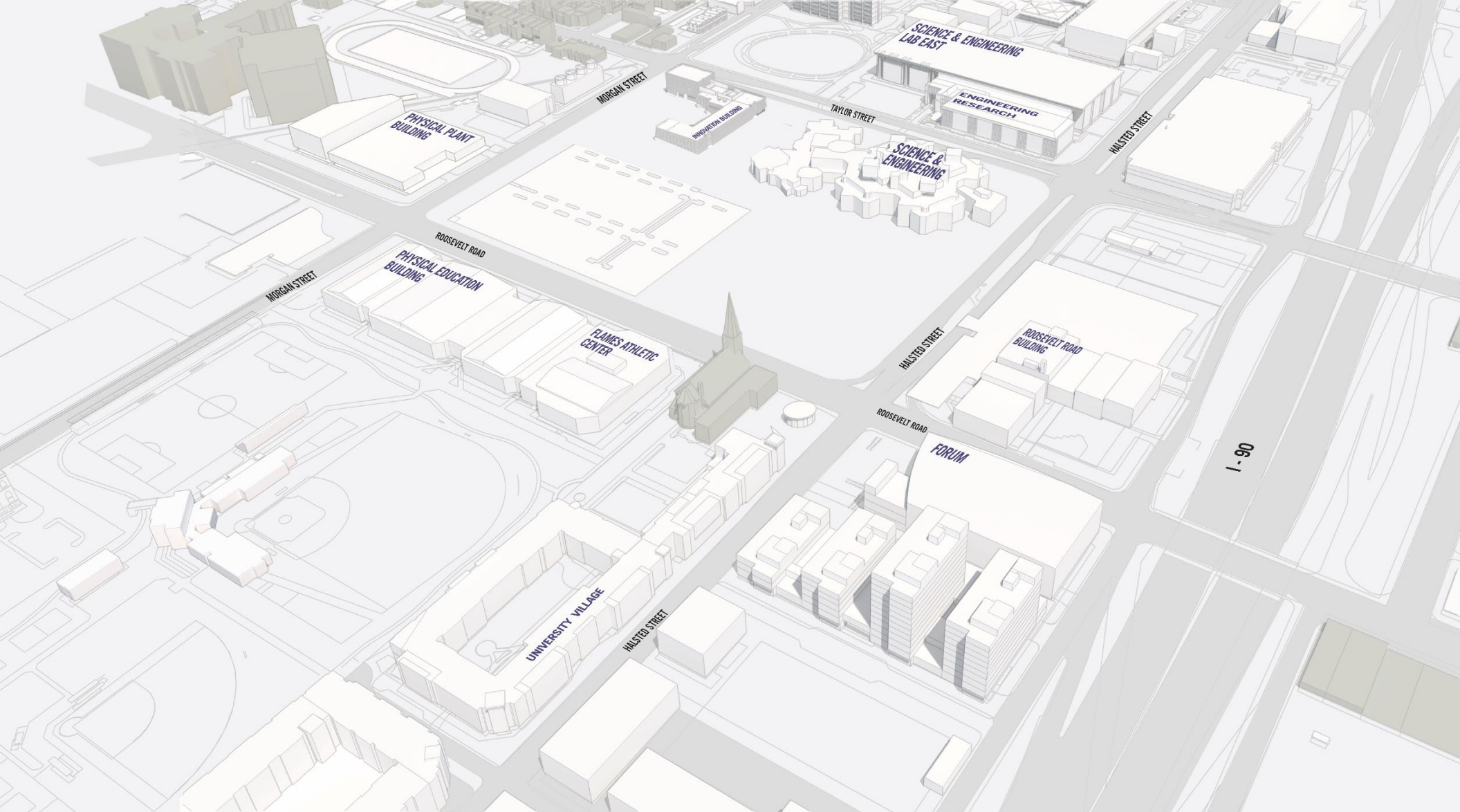
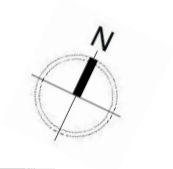

# East Campus South – Proposed Design Strategy

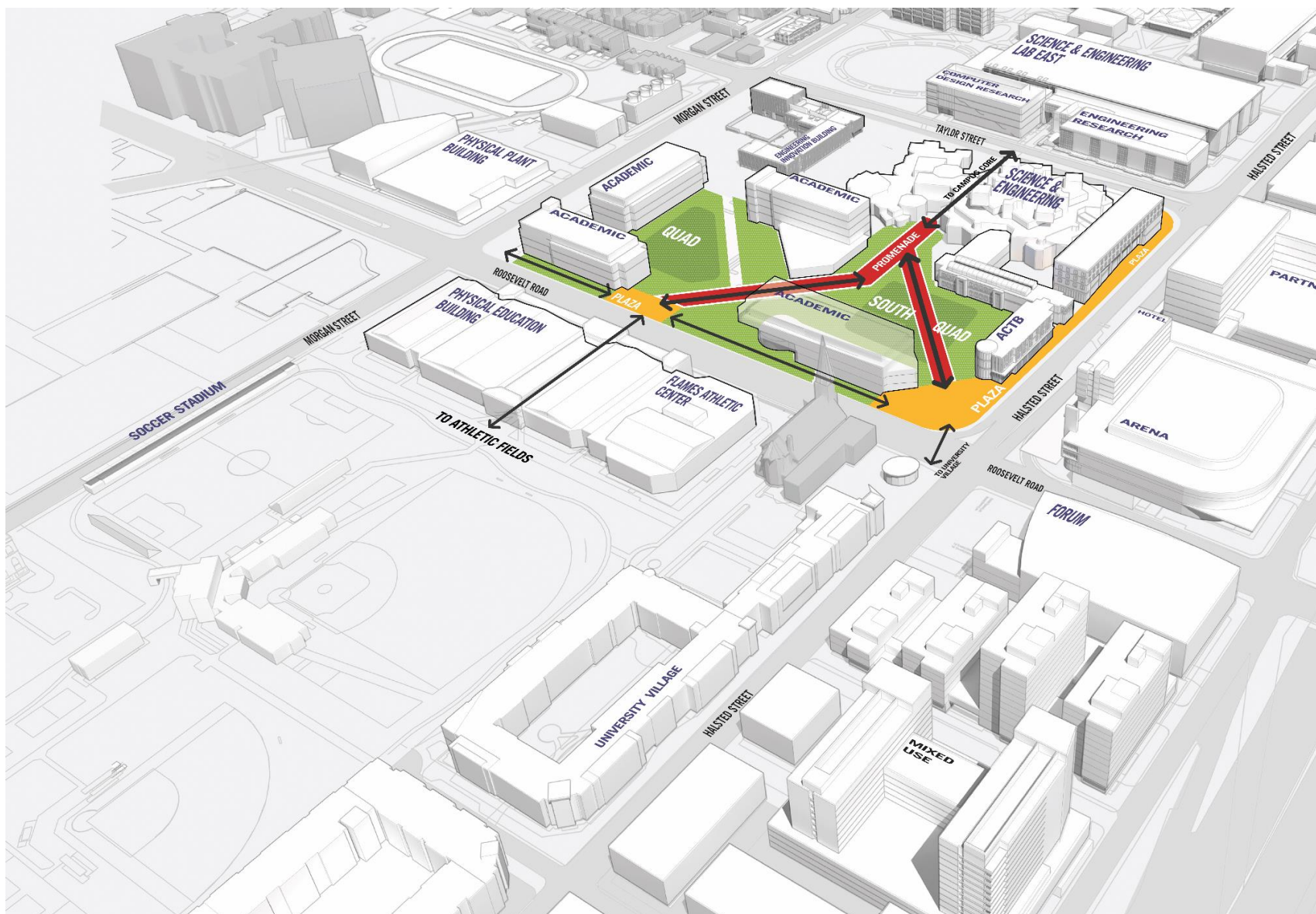

## ALIGN TO PRINCIPLES:

Create active, welcoming campus entries and edges

Build new facilities to support academic programs

Extend the collegiate feel of the campus core

Improve connections to and from the city

Create places for people to linger

Establish a variety of open space experiences

# East Campus South – Proposed Projects

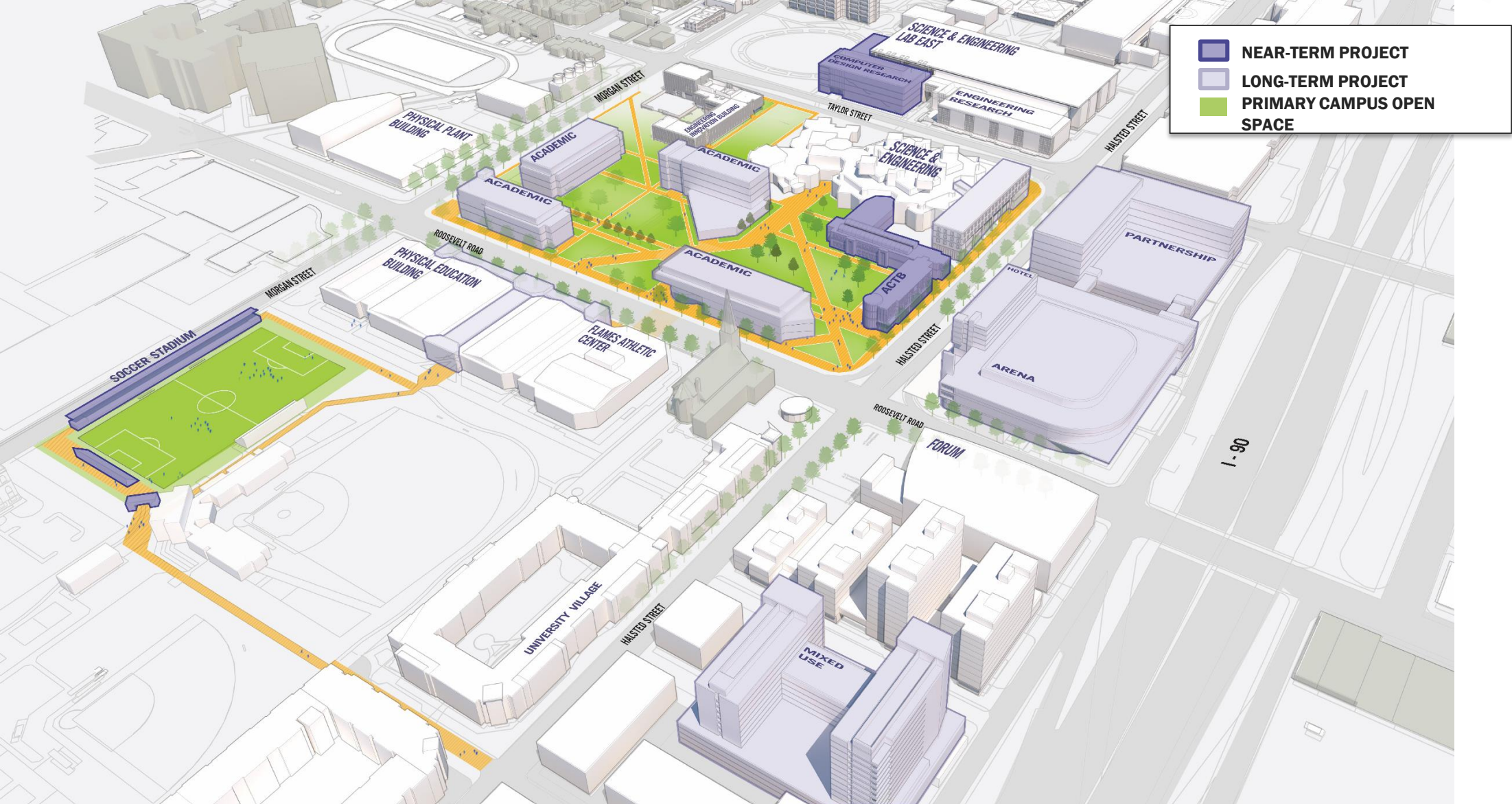

# Halsted & Roosevelt – Existing



# Halsted & Roosevelt – Proposed





**THE  
UNIVERSITY OF  
ILLINOIS  
AT  
CHICAGO**



# **UIC Master Plan Update:** 2018 Implementation Plan

**Presentation to the University of Illinois Board of  
Trustees  
November 15, 2018**